

Two-row angular ball bearing (ABB)
or taper roller bearing (TRB) at option

Shaft end
at option \varnothing 32 mm x 58 mm
or \varnothing 40 mm x 80 mm
or \varnothing 55 mm x 82 mm.
Customized shaft end available on
demand.

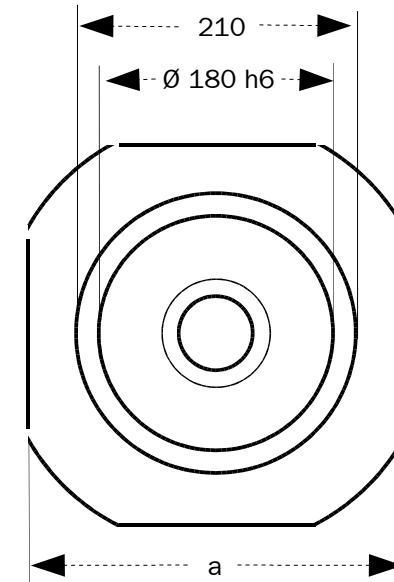

Motor type	Variant	Bearing	Length C	Length L1 with sensor	Length L2 with sensor and brake
NSTM 180/1	Quill	TRB	180	214.5	285
	Short Housing	ABB	125	201.5	285
NSTM 180/2	Quill	TRB	230	264.5	335
	Short Housing	ABB	175	251.5	335
NSTM 180/3	Quill	TRB	280	314.5	385
	Short Housing	ABB	225	301.5	385
	Housing IP 65	ABB	230	342.5	412
		ABB	217	329.5	399
NSTM 180/4	Quill	TRB	330	364.5	435
	Short Housing	ABB	275	351.5	435
	Housing IP 65	ABB	280	392.5	462
		ABB	267	379.5	449
NSTM 180/5	Housing IP 65	ABB	330	442.5	512
		ABB	317	429.5	499
NSTM 180/6	Housing IP 65	ABB	380	492.5	562
		ABB	367	479.5	549

Motor variant	Bearing	a
Quill	TRB	258
Short Housing	ABB	258
Housing IP 65	ABB	278
	ABB	249

Customized housings available on demand.

All motors can be equipped with stopping brakes

Various rotary encoders and resolvers available, e.g. Heidenhain Type ERN/ECN/EQN 1300.

Arrangement of connectors for motor and sensor can be made according to customer's preference when product is ordered.

More detailed drawings available on demand.
Subject to modifications and amendments.

Dimensions apply for 320 V DC versions. In case of versions with 560 V DC link voltage, the motors are approx. 10 mm longer.