

FIRST ANGLE PROJECTION

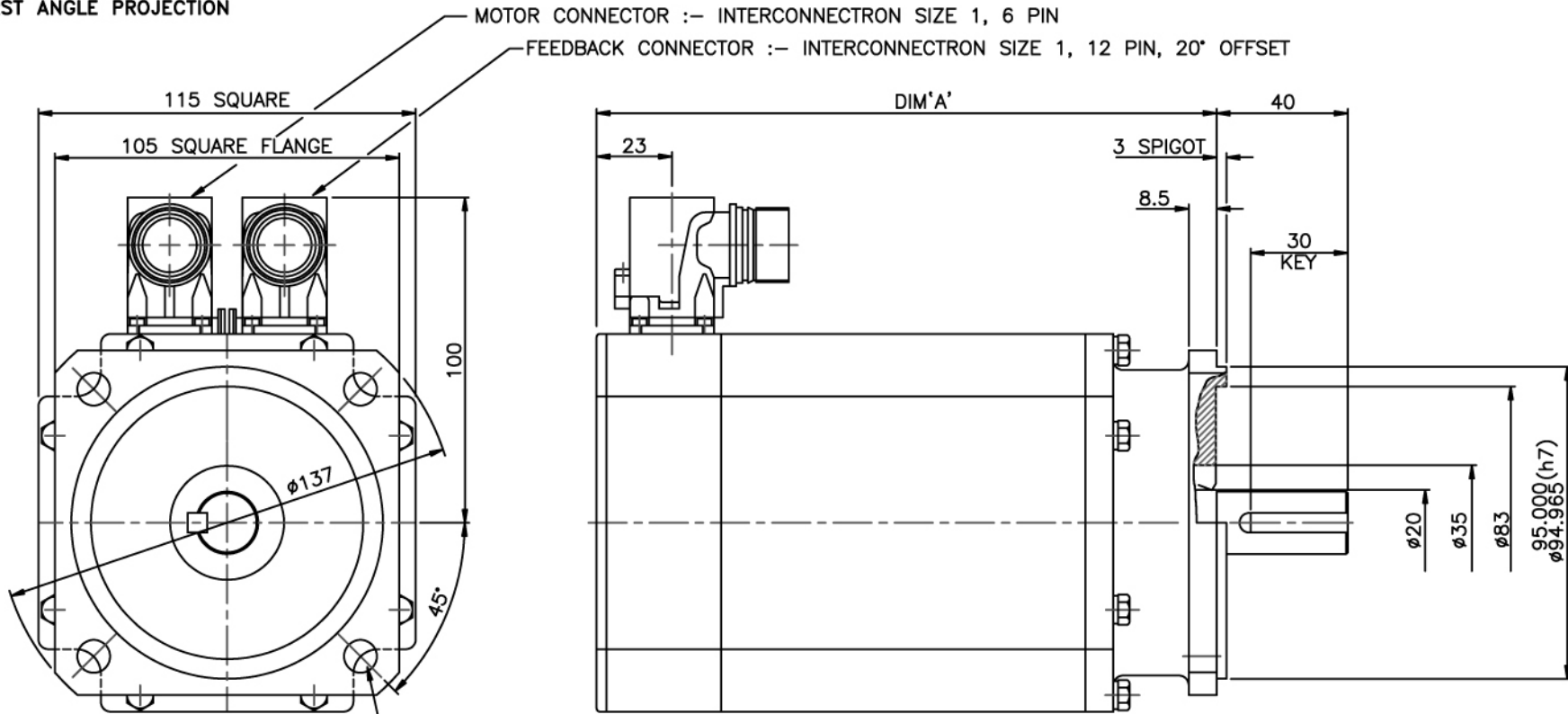

MOTOR CONNECTOR :- INTERCONNECTRON SIZE 1, 6 PIN
 FEEDBACK CONNECTOR :- INTERCONNECTRON SIZE 1, 12 PIN, 20° OFFSET

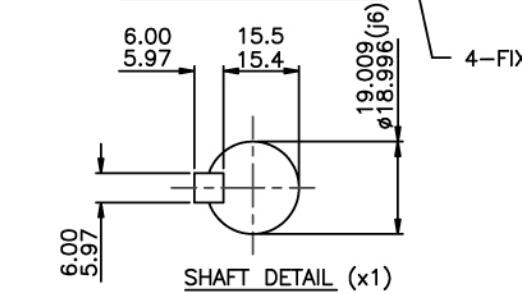

4-FIXING HOLES $\phi 10$ EQUI-SPACED ON 115 PCD

FRAME	NO BRAKE	WITH BRAKE
115A	189	209
115B	209	229
115C	229	249
115E	269	289
115G	309	329

2	12NOV03 MR3026 SHAFT EXTENSION & DE COVER SPIGOT TOLERANCES NOW SHOWN AS j6 & h7.	TITLE : OUTLINE HRS115 STD METRIC - RES + SIZE 1 CONNS.		DRAWING NO. 664-7-06332	SCALE	3:4
		MATERIAL	CODE		ISSUE No.	2
ALL DIMENSIONS IN MILLIMETRES TOLERANCES UNLESS ANG: $\pm 0.5^\circ$ OTHERWISE STATED DIM: $\pm 0.25\text{mm}$		SPEC	FORM	 für Dynamik und Bewegung	DR.	SIH
		FINISH	PATTERN No.		DATE	30JAN03
						A06332B1